



PLANER / MOULDERS

**Wood-Mizer®**





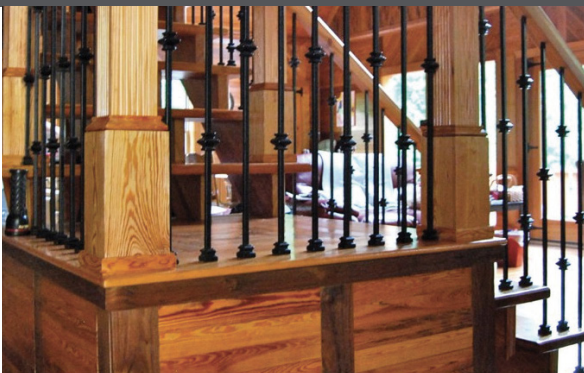

## CONTENTS

MP260 Planer/Moulder	6 - 7
MP360/365 Planer/Moulder	8 - 11
MP160 Planer & Thicknesser	12 - 13
MP180 Multi-Planer	14 - 15
MP200 Panel & Thicknesser	16 - 17
MF130 Verticle Spindle Moulder	18 - 19
MS300 Table Saw	12 - 13
Planer/Moulder Knives	22 - 23
Chip Extractor Systems	24 - 25
Frequently Asked Questions	26 - 27





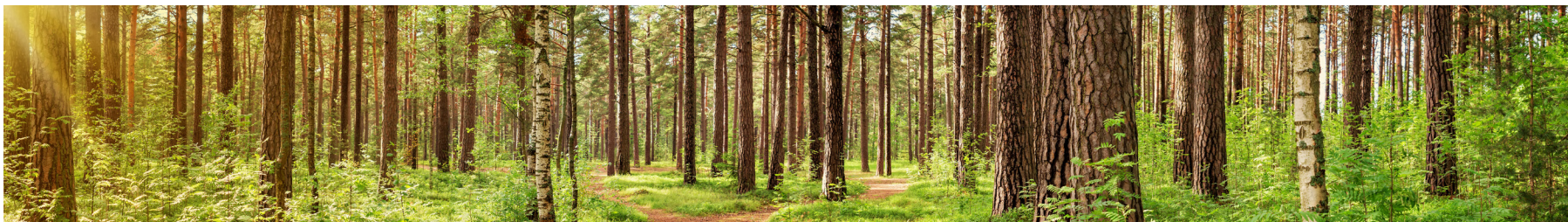

## UNLEASH YOUR CREATIVITY

Wood-Mizer is proud to now offer a workshop range of planer/moulders for anyone making finished timber, in addition to the legendary line of sawmills that have enabled people to process logs into timber for more than 35 years.

Engineered for professional woodworkers, carpenters, or joiners in the construction trade, Wood-Mizer planer/moulders plane and mould boards on all four sides in a single pass into a variety of professionally finished products including flooring, planed boards, crown moulding, cabinet trim, paneling, door and window frames, furniture components, and more.

The MP260, MP360 and MP365 planer/moulder machines have been manufactured in Sweden for more than 25 years and are tried, tested, and proven in workshops throughout the world under a variety of different brands. Today, the same machines are manufactured by the same dedicated team in the same facility in Sweden that is now owned by Wood-Mizer.

Wood-Mizer planer/moulders come with 2-year warranty and are backed by the same legendary service, quality and safety features shared by the entire family of Wood-Mizer wood processing equipment. From sawmills, resaws, and board edgers to drying kilns, Wood-Mizer is dedicated to providing you with everything you need to work with wood. With the addition of planer/moulders, Wood-Mizer now offers a full range of wood processing equipment that can seamlessly convert logs into finished wood products From Forest to Final Form®.



**INTRODUCING WOOD-MIZER 4-SIDED PLANER/MOULDER  
FOR FULL FLEXIBILITY TO PRODUCE FINISHED TIMBER**







Wood-Mizer planer/moulder factory in Östersund, Sweden.



# MP260

PLANER/MOULDER

## COMPACT & VERSATILE FOUR-SIDED PLANER/MOULDER



The MP260 four-sided planer/moulder is a versatile, compact machine engineered for professional woodworkers, carpenters, or joiners in the construction trade. Affordable and easy to use, the **MP260 planes and moulds boards on all four sides in a single pass** into a variety of professionally finished products including flooring, planed boards, crown moulding, cabinet trim, paneling, door and window frames, and furniture components.

### BENEFITS

### TOP 3

### BENEFITS

4-sided planing and profiling in one pass.

Large 4-sided cutting capacity - 260 mm wide x 100 mm high.

Easy to adjust, handle and use on a daily basis.

MP260 shown with optional 1.2 m infeed and outfeed tables, sold separately.

\* Minimum length of the material that can be processed - 500 mm



## MP260 MAIN FEATURES



**Centralized Control Panel**  
Allows the operator to start/stop all 4 cutter and power feed motors separately.

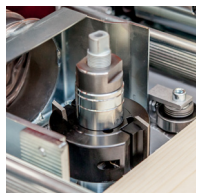

**Easy-to-change Knife Profiles**  
Changing knives is simple and takes approximately 10 to 20 minutes.



**Five Feed Rollers**  
Four steel and one polyurethane power roller steadily move the board through the machine.

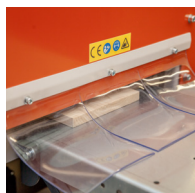

**Variable Feed Rate**  
Is adjustable from 2.5-14 m/min for 60 Hz.



**Adjustable Table Height**  
The table height is easily adjusted with a manual hand crank.

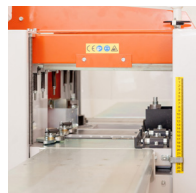

**Heavy-duty Construction**  
Built to last with a heavy-duty castiron table, durable sheet steel chassis and premium components.

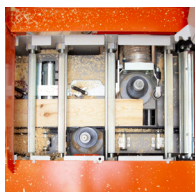

**4 Cutting Heads**  
Plane & mould boards on all 4 sides in a single pass into a variety of finished products.

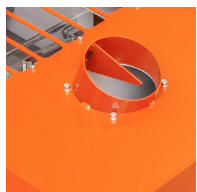

**Multiple Extraction Points**  
Located near the cutters connect with your chip extraction system to keep chips from building up in the machine.



**Large Viewing Window**  
Allows supervision of the entire cutting process from rough sawn boards to final products.

## OPTIONS &amp; ACCESSORIES

Planing & moulding knives (see pages 22-23)

Chip extractor systems

Infeed/Outfeed tables - 1.2 m each

Five polyurethane feed rollers (instead of standard 4 steel + 1 poliurethane)

Transport wheels

## DIMENSIONS &amp; WEIGHT

Length x Width 1100 mm x 900 mm

Height 970 mm

Weight 410 kg (Shipping Weight - 495 kg)



## SPECIFICATIONS

## CAPACITY

4-sided moulding	
Max. Width	260 mm
Height	10 - 100 mm
2-sided moulding	
Max. Width	300 mm
Height	10 - 230 mm
1-sided moulding or thickening	
Max. Width	410 mm
Height	230 mm

## UPPER HORIZONTAL CUTTER

Diameter	72 mm
Width	410 mm
Power	4 kW (5.5 HP)
Speed	6000 rpm 50Hz
Max. Cutting Depth	8 mm
Max. Profile Depth	20 mm

## LOWER HORIZONTAL CUTTER

Diameter	72 mm
Width	300 mm
Power	3 kW (4 HP)
Speed	6000 rpm 50Hz
Cutting depth	0 - 8 mm
Max. Profile depth	15 mm

## VERTICAL CUTTERS

Spindle diameter	30 mm
Max. Cutter Height	100 mm
Max. Diameter	140 mm
Power	3 kW (4 HP)
Rotation Speed	6000 rpm
Max. Cutting Depth	approx 30 mm

## STANDARD VERTICAL CUTTERS INCLUDED

Type	TB90 steel fzb
Diameter head	90 mm
Height head	40 mm
Blades type	HSS
Blades width	50 mm

## POWER FEED

Power	0.37 kW
Feed Speed	2.5-14 m/min 60 Hz
	2-12 m/min 50 Hz

## ELECTRICAL

Total Power	13.4 kW (18 HP)
Connection	3-phase, 400-440V, 16A or 230V, 20A
	1-phase, 230V, 32-50A



# MP360

PLANER/MOULDER

## HIGH PRODUCTION FOUR-SIDED MOULDER AND PLANER FOR FULL FLEXIBILITY TO PRODUCE FINISHED TIMBER

The MP360 four-sided planer/moulder is a high-production, large capacity machine engineered for professional workshops. With a larger capacity and higher hourly production levels than the popular Wood-Mizer MP260 planer/moulder, the MP360 planes and moulds boards on all four sides in a single pass into a variety of professionally finished products.



### BENEFITS

## TOP 3

### BENEFITS

4-sided planing and profiling in one pass.

Large 4-sided cutting capacity - 360 mm wide x 160 mm high.

Driven by 5 separate motors.

\* Minimum length of the material that can be processed - 500 mm



# HIGH PRODUCTION FOUR-SIDED PLANER AND MOULDER WITH UNIVERSAL SPINDLE

# MP365

PLANER/MOULDER

For the ultimate in workshop flexibility for producing whatever your client demands, the MP365 gives you the full functionality of a four-sided planer/moulder, plus a fifth spindle cutter that can tilt up to 270 degrees, so you can add additional profiles from any side, or attach sanding or brushing tools to deliver a final finish to your profiled timber.



## BENEFITS

## TOP 3

## BENEFITS

4-sided planing and profiling in one pass PLUS 5th spindle.

Large 4-sided cutting capacity - 360 mm wide x 160 mm high.

5th spindle rotates up to 270 degrees.

\* Minimum length of the material that can be processed - 500 mm



## MP360 / MP365 MAIN FEATURES



**Centralized Control Panel**  
Allows the operator to start/stop all 4 cutter and power feed motors separately.



**Easy-to-change Knife Profiles**  
Changing knives is simple and takes approximately 10 to 20 minutes.



**Adjustable Height**  
The table and machine height are adjusted together from 10-230 mm.

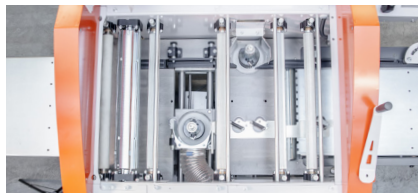

**Five Feed Rollers**  
Four steel and one polyurethane power roller steadily move the board through the machine.



**Variable Feed Rate**  
Is adjustable from 3.6-18 m/minute for 60 Hz.



**Heavy-duty Construction**  
Built to last with a heavy-duty cast iron table, durable sheet steel chassis and premium components.

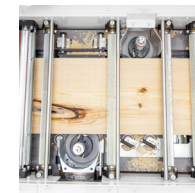

**4 Cutting Heads**  
Four cutting heads plane & mould boards on all 4 sides in a single pass into a variety of finished products.

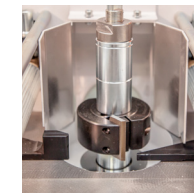

**Vertical Spindle**



**Multiple Extraction Points**  
Chip Extraction System connects to various extraction points to keep chips from building up in the machine.

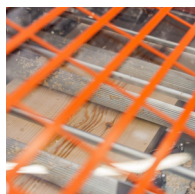

**Large Viewing Window**  
Allows to supervise the entire cutting process from rough sawn boards to final products.



**Height Gauge**  
Allows for accurate height adjustment of the machine and table.



**Width Gauge**  
Allows for accurate width adjustment to accommodate various sized material.



**Infeed & Outfeed Tables**  
1.2 m tables for added convenience when inserting and removing material from the machine.



**Board fence**  
800 mm

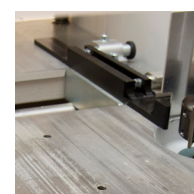

**Rear fence**  
Outfeed fence (430 mm length) with micro adjustment.

## MP365 MAIN FEATURE



**Fifth Universal Spindle – MP365 only**  
Tilts up to 270 degrees for additional profiling and versatility.

## MP360 / MP365 OPTIONS & ACCESSORIES



**Planing & moulding knives**  
(see pages 22-23)



**Support Rollers**  
Mounted on the infeed/outfeed table for additional support and control.



**Infeed table - 2 meters**  
Instand of standard infeed table 1.2 m. Must be ordered with machine inplace of standard table.

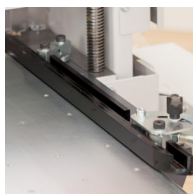

**Board fence**  
Available 3 different length of fence: shortened - 370 mm, extended - 1300 mm, extended - 2000 mm.

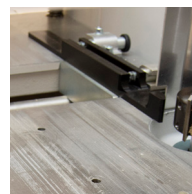

**Extended Rear fence**  
available 900 mm (standard 430 mm).



**Five polyurethane feed rollers**  
Guarantee the smoothest surface finishes by upgrading to 5 polyurethane rollers. (instead of 4 steel and 1 poliurethane)



**Chip Extractor Systems**  
(see page 24)





## OPTIONS & ACCESSORIES

Planing & moulding knives (see pages 22-23)

Support rollers

Infeed table - 2 m  
(must be ordered with machine in place of standard table)

Board fences:  
Shortened fence - 370 mm  
Extended fence - 1300 mm  
Extended fence - 2000 mm

Extended Rear fence - 900 mm (standard 430 mm)

Five polyurethane feed rollers (instead of standard 4 steel + 1 poliurethane)

Chip Extractor Systems (see page 24)

## MP360 DIMENSIONS AND WEIGHT

Length x Width	2970 mm x 1125 mm
Height	1.430 mm
Weight	675 kg (Shipping Weight - 740 kg)

## MP365 DIMENSIONS AND WEIGHT

Length x Width	3660 mm x 1125 mm
Height	1430 mm
Weight	1000 kg (Shipping Weight - 1120 kg)

## SPECIFICATIONS

### CAPACITY

Four-sided planing/moulding	
Max width	360 mm
Height range	10 - 160 mm
Two-sided planing/moulding	
Planing width	410 mm
Height range	10 - 230 mm
One-sided planing	
Max width	510 mm
Height	230 mm

### UPPER HORIZONTAL CUTTER

Diameter	88 mm
Width	510 mm
Power	5.5 kW (7.5 HP)
Rotation Speed	6000 rpm
Max. Cutting Depth	8 mm
Profile Depth	20 mm

### LOWER HORIZONTAL CUTTER

Diameter	72 mm
Width	410 mm
Power	4 kW (5.5 HP)
Rotation Speed	6000 rpm 50 Hz
Cutting Depth	0 - 8 mm
Profile Depth	max 10 mm (slot drill 15 mm)

### VERTICAL CUTTERS

Spindle Diameter	30 mm
Max. Cutter Height	160 mm
<b>Max. Diameter</b>	<b>MP360 - 140 mm</b> <b>MP365 - 160 mm</b>
Power	3 kW (4 HP)
Rotation Speed	6000 rpm
Max. Cutting Depth	30 mm

### STANDARD CUTTERS INCLUDED

Type	TB90 steel
Body diameter	90 mm
Body height	40 mm
Cut type	plate HSS
Cutting width	50 mm

### UNIVERSAL SPINDLE – MP365 only

Spindle Diameter	30 mm
Max. Cutter Height	130 mm
Max. Diameter	200 mm
Power	3 kW (4 HP)
Rotation Speed	3000, 6000, 9000 rpm
Tilt	270 degrees
Operating height	500 mm
Lateral movement	350 mm
Tool height	max 130 mm

### POWER FEED

Power	0.75 kW
Feed Speed	3-15 m/min 50Hz

### ELECTRICAL

Total Power	<b>MP360 - 16.25 kW (22 HP)</b> <b>MP365 - 19.25 kW (26 HP)</b>
Connection	3-phase 400V, 20-32A 3-phase 230V, 32-50A



# MP160

PLANER & THICKNESSER

## TWO ESSENTIAL WORKSHOP TOOLS IN ONE MACHINE!



Every workshop needs a jointer and a planer (Planer/Thicknesser) in order to produce accurately dimensioned boards. With Wood-Mizer's MP160 Jointer/Planer (Planer/Thicknesser), you get both in one efficient and compact machine! Take your bowed or cupped rough sawn timber and get it in perfect shape for whatever project you have in mind.

The MP160 efficiently shares one horizontal cutter between two cast iron tables – the upper table for jointing (planing) and the lower table for planing

### BENEFITS

## TOP 3

### BENEFITS

4 step process to produce square & straight material

For producers of furniture, windows, doors and more

Use jointer & planer without any setup between modes



(thicknessing). No alterations are needed to switch between jointing (planing) and planing (thicknessing) – switch between the two functions easily without stopping the cutter or extractor. You start by using the top table for jointing (planing) – making two adjoining sides perfectly flat and at a precise right angle to each other. You manually advance the board over the cutter by hand. Then you use the bottom table for planing (thicknessing) the last two sides to be parallel to the first two, thicknessing the board to its final dimensions.

### ACCESSORIES

Planer blades HSS 410 mm
Planer blades HM 410 mm
Indexable blades
Wheel set
Wedges for profile blades
Extension tables on thicknesser table MP160

### OPTIONS

4-blades horizontal cutter
Planetary gear for stepless feeding between 2-12 m/min
Indexable blades with holder

### DIMENSIONS AND WEIGHT

Length x Width	1040 mm x 720 mm
Height	1100 mm
Weight	195 kg (Shipping Weight - 220 kg)

A safety guard keeps your hands safe during jointing (planing). The board fence tilts up to 45 degrees for jointing angled boards. The top and bottom tables can be adjusted as needed, and the infeed and outfeed tables always remain parallel to each other. The outfeed table can be fine-adjusted. Two power rollers pull your board under the cutter. The power feed has an industrial gearbox.

The MP160 is all you need to produce furniture-grade timber.



### SPECIFICATIONS

#### CAPACITY

Planer with	310 mm
Planer table length	1400 mm
Planer, chip thickness	8 mm
Planer fence	152 x 1100 mm
Thicknesser width	410 mm
Thicknesser height	260 mm
Thicknesser, table length	630 mm
Thicknesser, chip thickness	4 mm
Horizontal cutter diameter	72 mm
Feed rolls diameter	32 mm
Feed speed	5 m/min
Planetary gear for step less feeding	2-12 m/min

#### POWER FEED

Planer motor	3 kW (4 HP), 3-phase
Planer motor	2.2 kW (3 HP), 1-phase
Spindle speed	5600 rpm
Feeding motor	0.18 kW (0.25 HP), 3-phase
Feeding motor planetary gear	0.37 kW (0.5 HP), 3-phase



# MP180

MULTI-PLANER

*PRODUCE FINISHED TIMBER FASTER,  
AND MOULD AS WELL!*



With the MP180, you have all the benefits of having a jointer and planer (planer and thicknesser) in one machine to produce flat faces and squared timber, while adding a side cutter to the lower bottom table where the planer (thicknesser) is. Take your bowed or cupped rough sawn timber and produce finished square boards and mouldings.

You start by using the top table for jointing (planing) – making two adjoining sides perfectly flat and at a precise right angle to each other. Then you can use the bottom table for planing (thicknessing) the last two sides at the same time, thicknessing the board to its final dimensions, and cutting down on an additional step. Moulding knives can be inserted into the side cutter, so you can also mould profiles as well. The horizontal cutter can also be fitted with profile knives with a maximum profile of 2 mm.

## BENEFITS

## TOP 3

## BENEFITS

2 or 3 step process to produce 4-sided planed or moulded timber

For producers of furniture, windows, doors, flooring, mouldings and more

Use jointer, planer and moulder (planer, thicknesser and moulder) without any setup between modes



By utilizing the horizontal cutter for planing (thicknessing) and the vertical side cutter to mould, you can use the machine to joint, plane and mould (thickness, plane and mould) without having to reconfigure or significantly adjust the machine.

This design allows you to produce tongue and groove boards in two passes instead of the usual six to eight passes required with standard machinery. This unique combination makes the MP180 the obvious choice for carpenters who are looking for cost efficiency, versatility and precision in one machine.

The MP180 will enable you to produce high quality furniture-grade timber and mouldings.

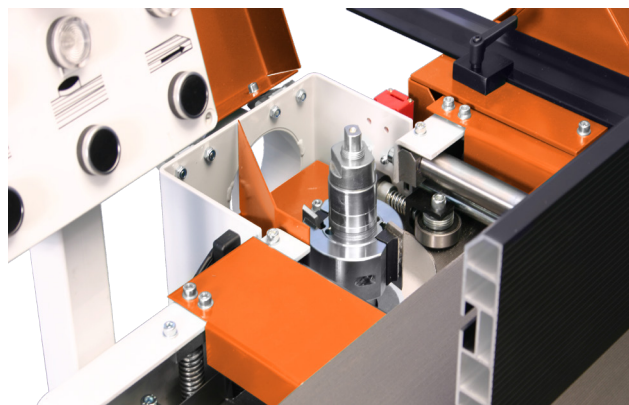

## SPECIFICATIONS

### CAPACITY

Planer with	310 mm
Planer table length	1400 mm
Planer, chip thickness	8 mm
Planer fence	152 x 1100 mm
Thicknesser width	410 mm
Thicknesser height	260 mm
Thicknesser, table length	830 mm
Thicknesser, chip thickness	4 mm
Moulding height	100 mm
Moulding width	310 mm
Horizontal profile depth	2 mm
Horizontal cutter diameter	72 mm
Feed rolls diameter	32 mm
Feed speed	5 m/min
Planetary gear for step less feeding	2-12 m/min
Spindle diameter, vertical moulder	30 mm
Tool diameter, vertical moulder	140 mm

### POWER FEED

Planer motor	3 kW (4 HP), 3-phase
Vertical moulder motor	2.2 kW (3 HP), 3-phase
Spindle speed	5600 rpm
Feeding motor	0.18 kW (0.25 HP), 3-phase
Feeding motor planetary gear	0.37 kW (0.5 HP), 3-phase



## ACCESSORIES

Planer blades HSS 410 mm
Planer blades HM 410 mm
Indexable blades
Wheel set
Wedges for profile blades
Extension tables

## OPTIONS

4-blades horizontal cutter
Planetary gear for stepless feeding between 2-12 m/min
Indexable blades with holder

## DIMENSIONS AND WEIGHT

Length x Width	1040 mm x 720 mm
Height	1150 mm
Weight	275 kg (Shipping Weight - 300 kg)

# MP200

PANEL & THICKNESSER

## PLANE AND MOULD UP TO TWO SIDES AT ONE TIME



With the MP200 Planer/Moulder, you can plane and mould on one or two sides at once to produce mouldings or flooring. The MP200 includes 1 horizontal top cutter, and 1 vertical side cutter. Both can be fitted with planing knives or moulding profile knives.

You begin by planing or moulding one or two adjoining sides in one pass. The power feed rollers move the board under the horizontal cutter and past the vertical side cutter. If you are just planing, then you can simply flip the board over, adjust the table height, and then plane the final two sides.

### BENEFITS

## TOP 3

### BENEFITS

2 step process to produce planed and moulded timber

For producers of flooring, mouldings and more

1 horizontal cutter and 1 side cutter



If you are moulding a profile, then you simply need to change out the knives, adjust the table height and then mould the final two sides.

With the MP200, you can plane and mould timber in only two passes.

## ACCESSORIES

- Planer blades HSS 410 mm
- Planer blades HM 410 mm
- Indexable blades
- Wheel set
- Wedges for profile blades
- Extension tables

## OPTIONS

- 4-blades horizontal cutter
- Planetary gear for stepless feeding between 2-12 m/min
- Indexable blades with holder

## DIMENSIONS AND WEIGHT

Length x Width	1270 mm x 840 mm
Height	1220 mm
Weight	225 kg (Shipping Weight - 250 kg)

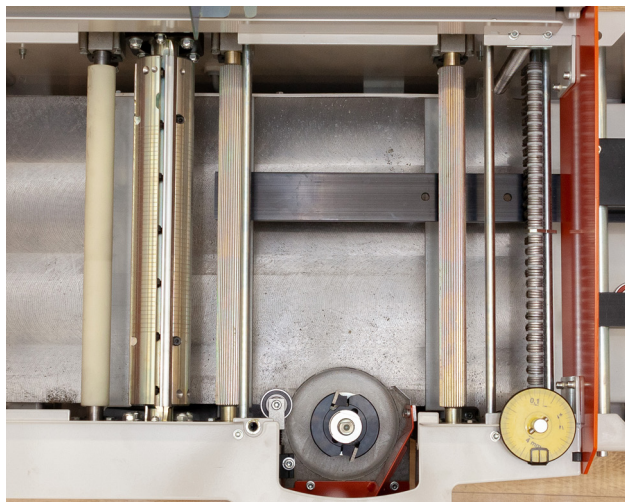

## SPECIFICATIONS

### CAPACITY

Thickener width	410 mm
Thickener height	260 mm
Thickener, table length	830 mm
Thickener, chip thickness	6 mm
Moulding height	100 mm
Moulding width	310 mm
Horizontal profile depth	10 mm
Horizontal cutter diameter	72 mm
Feed rolls diameter	32 mm
Feed speed	5 m/min
Planetary gear for step less feeding	2-12 m/min
Spindle diameter, vertical moulder	30 mm
Tool diameter, vertical moulder	140 mm

### POWER FEED

Planer motor	3 kW (4 HP), 3-phase
Vertical moulder motor	2.2 kW (3 HP), 3-phase
Spindle speed	5600 rpm
Feeding motor	0.18 kW (0.25 HP), 3-phase
Feeding motor planetary gear	0.37 kW (0.5 HP), 3-phase

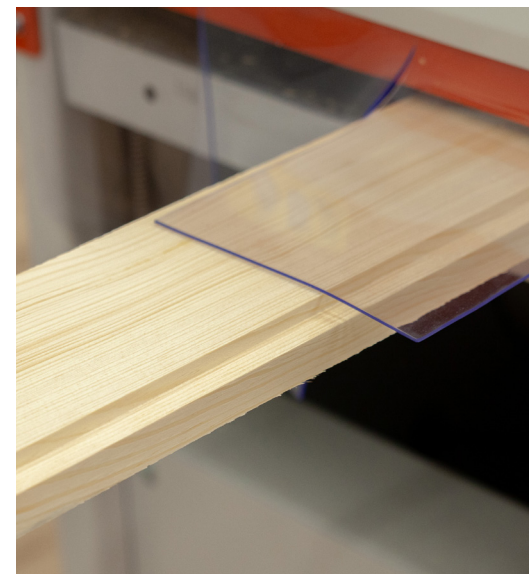

# MF130

VERTICLE SPINDLE MOULDER

## ULTIMATE FLEXIBILITY TO PRODUCE UNIQUE WOOD PRODUCTS



The MF130 is the answer when you need more flexibility to produce many varieties of unique products in your workshop. Designed for ultimate versatility, you can use the MF130 for straight moulding, curved moulding, routing, tenoning and more!

The spindle can be raised or lowered, and with a tiltable range of 270 degrees, the cutter or router bit can machine the board from below, the sides and from above – at almost any angle. You can mould one board on all four sides, as well as mould the ends of the board, and router holes into the surface – all with the MF130's single spindle being uniquely configured for each operation.

### BENEFITS

## TOP 3

### BENEFITS

1 multifunction spindle with adjustable angle and position

For producers of windows, doors and more

Stable construction, flexible configuration & options for a variety of uses



Boards are passed through the machine with a sliding table, held down with included clamps, or they can be passed over the cutter manually. Additional options are available to expand the possibilities of the MF130 such as a multi-directional table, curved fences for making curved mouldings, and even a power feed.

When you need ultimate flexibility from one machine – the MF130 is the answer!



## SPECIFICATIONS

### TECHNICAL DATA

Spindle diameter, standard	30 mm
Router spindle, option	6-20 mm
Max cutter diameter	200 mm
Max cutter height	130 mm
Spindle speeds	3000, 6000, 9000 r/min
Router spindle speeds	3000, 6000, 9000, 14000 r/min
Fence, size	152 mm

### MOVEMENTS SPINDLE

Tilting	270 deg
Vertically	500 mm
Horizontally	350 mm
Motor	3-phase 400 V (230 V)
Motor power	3 kW (4 HP)

### DIMENSIONS

Sliding table length	1100 mm
Sliding table width	350 mm
Sliding length	1087 mm
Table length	900 mm
Table width, total	750 mm
Table height	850 mm
Weight	375 kg



## ACCESSORIES

Guard for horizontal position
Guard for router spindle
Extra clamp
Attachment for curved mouldings
In- and out-feed table
Spindle 1 1/4" and Spindle short
Support table, XY-table
Router spindle
Power feeder and power supply for feeder

## DIMENSIONS AND WEIGHT

Length x Width	1100 mm x 350 mm
Height	850 mm
Weight	375 kg (Shipping Weight - 400 kg)

# MS300

TABLE SAW

## THE WELL-BALANCED PRECISION TABLE SAW WITH LARGE CAPACITY!



The MS300 is a solid precision table saw with large capacity and a minimal footprint, making it ideal for any workshop. Its cast iron base and wide sliding table enables you to achieve high accuracy and repeatability cut after cut.

With a large cutting depth, a 45 degree tilting capacity, and large rip capacity makes this saw Ideal for the professional workshop. The base is made from cast iron for sturdy and stable operation. The sliding table runs on large ball bearings for smooth and accurate cuts. The angle and the height of the blade can be precisely adjusted. The board fence is micro-adjustable when you need absolute precision. The angled fence on the sliding table can be positioned on either side of the

### BENEFITS

## TOP 3

### BENEFITS

Saw blade guard mounted on the riving knife

Rip fence with micro adjustment

Mitre fence with serial stop, L 1100 mm



## MS300 MAIN FEATURES



**Blade Angle**  
Adjusts 0-45 degrees.



**Board Fence**  
Adjustable to tenths of a millimetre.

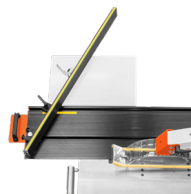

**Adjustable Angle of Sliding Table Fence.**



**Suva Blade Guard**



**Solid Sliding Table**

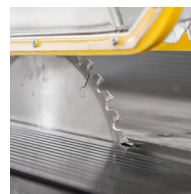

**Saw Blade**

table, depending on whether you need to push the wood with the fence, or against the fence during the cut.

Various options are available like a SUVA blade guard, and an extension for the sliding table. Chip extraction is located under the blade, and the blade guard can also be connected to a chip extractor. Additional material clamps and circular blades for various kinds of material are available.

If you need a compact table saw but also need truly professional accuracy and dependability, the MS300 is for you.

## OPTIONS &amp; ACCESSORIES

SUVA guard
Extension tables for the rip fence 440 mm x 900 mm
Extra extension table for sliding table 500 mm x 350 mm
Clamping device for sliding table
Saw blades
Shorter sliding table, 1100 mm

## DIMENSIONS AND WEIGHT

Length x Width	900 mm x 750 mm
Height	850 mm
Weight	295 kg (Shipping Weight - 320 kg)

## SPECIFICATIONS

## CAPACITY

Saw height	103 mm
Spindle diameter, standard	30 mm
Saw blade diameter	315 mm
Tilting saw blade	0-45 deg

## DIMENSIONS

Length between saw blade and rip fence	800 mm
Sliding table length	1100 mm or 1400 mm
Sliding table width	350 mm
Sliding length	1085 mm or 1235 mm
Table length	900 mm
Table width, total	750 mm
Extension table on sliding table, L x W	500 mm x 350 mm
Table height	850 mm
Table weight	95 kg

## MOTOR

Motor power, 3-phase	3 kW (4 HP)
Motor power, 1-phase	2.2 kW (3 HP)
Spindle speed	4400 rpm



## SAW BLADES

We offer three types of circular blades for the MS300 Table Saw with varying number of teeth depending on the material species, height and feed rate.

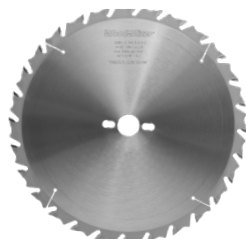

**TRB315.028.30/MF**  
With 28 teeth, this blade is recommended for cutting solid wood.



**TCB315.054.30**  
With 54 teeth, this blade can be used for both solid wood and panels depending on the feed rate.



**TCC315.072.30**  
With 72 teeth, this blade is recommended for cutting panels.

## PLANING & MOULDING KNIVES

WOOD-MIZER OFFERS A RANGE OF PLANING/MOULDING KNIVES TO PRODUCE THE EXACT PRODUCT YOU NEED FOR YOUR PROJECT



Our Knives are easy to change and set.



### STRAIGHT PLANER KNIVES

We offer straight planer knives for both of the MP260 and MP360 planer/moulders:

**TPK300.20HS** – MP260 lower cutter knife

**TPK410.20HS** – MP260 upper cutter knife, MP360 lower cutter knife

**TPK510.25HS** – MP360 upper cutter knife

**TPK510.30HS** – MP360 upper cutter knife (optional)





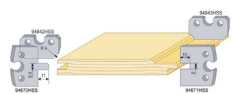

Interior and Exterior Siding and Paneling. Radius 4 Tongue and Groove.



Decking Radius 3

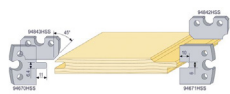

Interior and Exterior Siding and Paneling. V-Joint. Tongue and Groove.

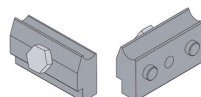

KIL-038 Wedge



Exterior and Interior Shiplap. 12.7mm Rabbet.



Interior and Exterior Panelling. Tongue and Groove.

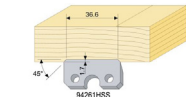

Back Cut-Out Relief Knife for Siding and Panelling.

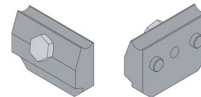

KIL360-038 Wedge

## MP260 BASIC KNIFE SET

**TPPKMP260** – This package includes 9 pairs of profile knives (40 mm) for producing siding, panelling, shiplap, and decking. The MP260 basic set comes with 3 pairs of KIL-038 wedges.

## MP360 BASIC KNIFE SET

**TPPKMP360** – This package includes 9 pairs of profile knives (40 mm) for producing siding, panelling, shiplap, and decking. The MP360 basic set comes with 2 pairs of KIL360-038 wedges and 1 pair of KIL-038 wedges.



Interior and Exterior Siding and Paneling. Radius 4 Tongue and Groove.

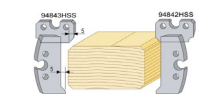

Decking V-Joint 45, thickness adjustable between 13-51mm.

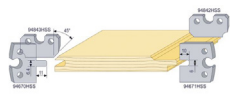

Interior and Exterior Siding and Paneling. V-Joint. Tongue and Groove.

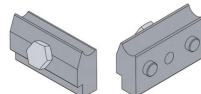

KIL-038 Wedge



Exterior and Interior Shiplap. 12.7mm Rabbet.



Interior and Exterior Panelling. Tongue and Groove.

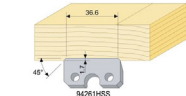

Back Cut-Out Relief Knife for Siding and Panelling.

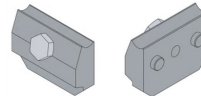

KIL360-038 Wedge

## MP260 EXTENDED KNIFE SET

**TPPKMP260EXT** – This package includes 11 pairs of profiling knives (40 mm), 4 pairs of profile knives (60 mm) for producing siding, panelling, shiplap, and decking. The MP260 extended set comes with 3 pairs of KIL-038 wedges.

## MP360 EXTENDED KNIFE SET

**TPPKMP360EXT** – This package includes 11 pairs of profiling knives (40 mm), 4 pairs of profile knives (60 mm) for producing siding, panelling, shiplap, and decking. The MP360 extended set comes with 3 pairs of KIL360-038 wedges plus 1 pair of KIL-038 wedges.

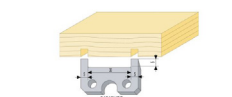

Back Cut-Out Relief Knife for Siding and Panelling.

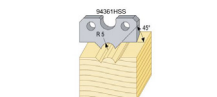

Top Cut-Out Pearl Profile.



Interior and Exterior Siding and Paneling. V-Joint. Tongue and Groove.

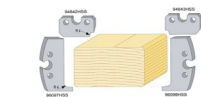

Decking Radius 4, thickness adjustable between 13-51mm.

**A wide variety of knife profiles is available. Please call for details.**

# CHIP EXTRACTOR

SYSTEMS

**OUR CHIP EXTRACTOR SYSTEMS ARE MODULAR IN ORDER TO MEET YOUR SPECIFIC NEEDS.**



## **MD400 – CHIP EXTRACTOR BASE**

The heart of the system is a sturdily built, customisable steel extractor with a flow rate of 4000 m<sup>3</sup>/h. Depending on your extraction needs, the outlet can be pointed in different directions and the inlet can be mounted on two sides. Motor 3 kW (4 HP). Suction inlets are 3 x 100 mm + 1 x 125 mm. Outlet size is 200 mm.

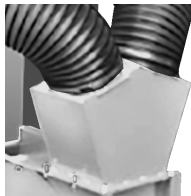

## **MD500 – CHIP EXTRACTOR BASE**

The heart of the system is a sturdily built, customisable steel extractor with a flow rate of 4000 m<sup>3</sup>/h. Depending on your extraction needs, the outlet can be pointed in different directions and the inlet can be mounted on two sides. Motor 4 kW (5.5 HP). Suction inlets are 5 x 100 mm + 1 x 125 mm. Outlet size is 250 mm.



**301-004  
Wheeled Chip  
Extraction System**  
Complete extraction system that includes filter, cyclone, and chip collection bags.  
(for MP260 and MP160)



**301-006  
Floor-mounted Chip  
Extraction System**  
Complete extraction system that includes filter, cyclone, and chip collection bags.  
(for MP260 and MP160)



**301-007  
Chip Extraction System  
for Chip Containers**  
Complete extraction system that includes filter, cyclone and chip collection bags. For use with a chip container. Delivery hose between cyclone and fan allows the fan to be located away from the cyclone system. Collection bag size is 2 x 250 litres.  
(for MP260 and MP160)

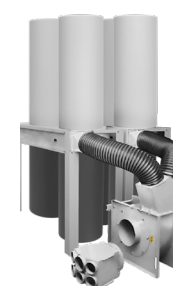

**Chip Extraction System**  
Complete extraction system that includes: MD500 and 302-000, 310-500, 310-501, 2x 301-008. The hose should be added in needed length. Floor mounted.  
(for MP360 and MP365)







## FREQUENTLY ASKED QUESTIONS

### 1. Why is Wood-Mizer introducing Planer/Moulders?

**A:** From sawmills, resaws, and board edgers to log splitters and kilns, Wood-Mizer is committed to giving you everything you need to work with wood. For more than 35 years, our sawmill customers have shared amazing finished homes and furniture they have built with lumber milled on their Wood-Mizer sawmills and supporting woodworking equipment. With the addition of planer/moulders, Wood-Mizer now offers our customers a more complete and growing range of equipment that can seamlessly convert logs into finished wood products From Forest to Final Form®.

### 2. Where are Wood-Mizer Planer/Moulders manufactured?

**A:** Wood-Mizer Planer/Moulders are made in Sweden by a dedicated team who has designed and manufactured the popular range of woodworking machinery sold under a variety of brands for more than 25 years. The founder, owner, and engineer of these machines, Bo Mårtensson, has joined Wood-Mizer as the General Director of the factory in Ostersund, Sweden adding to Wood-Mizer's growing manufacturing plants throughout the world.

### 3. How do Wood-Mizer Planer/Moulders compare to other popular brands?

**A:** Wood-Mizer is proud to offer planer/moulders that have been tried, tested, and proven in workshops throughout the world for more than 25 years. The machines are well-known in the industry and are used by many of our sawmill customers to add value to their rough sawn boards. Today, the same machines are manufactured by the same company in the same facility in Sweden that is now owned by Wood-Mizer. Since Wood-Mizer manufactures their own planer/moulders, customers receive factory-direct pricing along with the same legendary service, quality, and safety features shared by the entire family of Wood-Mizer wood processing equipment.







#### 4. What kind of maintenance is required?

**A:** With 2 year warranty, Wood-Mizer Planer/Moulders are built to last with heavy duty cast-iron, tables, durable sheet steel chassis, and premium quality components to minimize maintenance requirements. Parts and service are available through the Wood-Mizer worldwide distribution network.

#### 5. What are the installation requirements?

**A: Power** - 3-phase or single-phase power connection at 16A, 400-415V or 230V.

**Chip Extractor** - A proper extraction system is needed to adequately keep chip from building up in the machine. Wood-Mizer provides multiple chip extraction and cyclone bagging systems depending on your operation needs. **Knives** - Four sets of planing knives are included with each machine. Wood-Mizer also offers a Basic and Extended moulding knife kit and some replacement knives to help produce what you need for your project or client.



**Wood-Mizer Industries Sp. z o.o.**

European Headquarters and Manufacturing Facility

Nagórna 114, 62-600 Koło, Poland

[woodmizer-europe.com](http://woodmizer-europe.com)



tel.: +48 63 26 26 000